

# Glenair IPT Series Alternate Key Positions

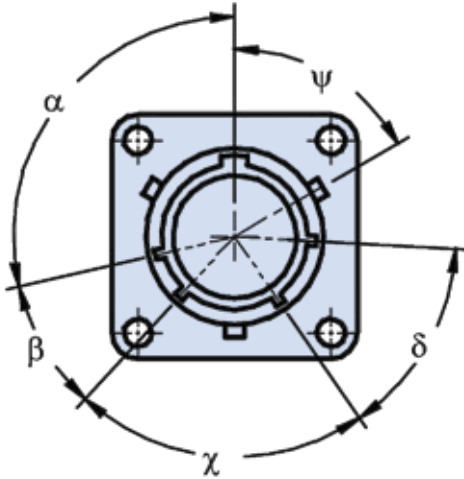

Shell size	N Polarization				
	α	β	χ	δ	ψ
8	105	35	75	50	60
10	105	35	75	50	60
12	105	35	75	50	60
14	105	35	75	50	60
16	105	35	75	50	60
18	105	35	75	50	60
20	105	35	75	50	60
22	105	35	75	50	60
24	105	35	75	50	60

Shell size	B Polarization				
	α	β	χ	δ	ψ
8	-	-	-	-	-
10	85	35	75	50	40
12	89	35	75	50	44
14	91	35	75	50	46
16	93	35	75	50	48
18	95	35	75	50	50
20	95	35	75	50	50
22	97	35	75	50	52
24	97	35	75	50	52

Shell size	C Polarization				
	α	β	χ	δ	ψ
8	-	-	-	-	-
10	125	35	75	50	80
12	121	35	75	50	76
14	119	35	75	50	74
16	117	35	75	50	72
18	115	35	75	50	70
20	115	35	75	50	70
22	113	35	100	50	68
24	113	35	75	50	68

Shell size	E Polarization				
	α	β	χ	δ	ψ
8	118	30	100	30	73
10	115	30	100	30	70
12	115	30	100	30	70
14	75	30	100	30	30
16	75	30	100	30	30
18	75	30	100	30	30
20	75	30	100	30	30
22	75	30	75	30	30
24	75	30	100	30	30

Shell size	F Polarization				
	α	β	χ	δ	ψ
8	82	50	75	45	47
10	85	50	75	45	50
12	85	50	75	45	50
14	120	50	75	35	75
16	120	50	75	35	75
18	120	50	75	35	75
20	120	50	75	35	75
22	120	50	75	35	75
24	120	50	75	35	75

The 3 mating pins are 120° spaced.  
 The picture shows a receptacle connector.  
 The key orientation on plug connectors is clockwise.  
 IAW BS9522 F0017.