

| Arrangement | Cl. Isol. Rating | Dim. contact size | |
|-------------|------------------|-------------------|------------|
| | | 20 | 16 |
| 8 - 2 | I | 2 | |
| 8 - 3 | I | 3 | |
| 8 - 3A | I | 3 | |
| 8 - 4 | I | 4 | |
| 8 - 33 | I | 3 | |
| 10 - 2 | II | | 2 |
| 10 - 6 | I | 6 | |
| 10 - 7 | I | 7 | |
| 10 - 8 | I | 8 | |
| 10 - 98 * | I | 6 | |
| 12 - 3 | II | | 3 |
| 12 - 4 | I | | 4 |
| 12 - 8 | I | 8 | |
| 12 - 10 | I | 10 | |
| 12 - 14 | I | 14 | |
| 12 - A6 | I | | 6 |
| 14 - 5 | II | | 5 |
| 14 - 12 | I | 8 | 4 |
| 14 - 12/3 | II | | 12 |
| 14 - 14 * | I | 14 | |
| 14 - 15 | I | 14 | 1 |
| 14 - 18 | I | 18 | |
| 14 - 19 | I | 19 | |
| 16 - 2 | I | | 2 x 16-2.5 |
| 16 - 8 | II | | 8 |
| 16 - 23 | I | 22 | 1 |
| 16 - 26 | I | 26 | |
| 16 - 99 | I | 21 | 2 |
| 18 - 11 | II | | 11 |
| 18 - 30 * | I | 29 | 1 |
| 18 - 32 | I | 32 | |
| 20 - 16 | II | | 16 |
| 20 - 24 | I | 24 | |
| 20 - 25 * | I | 25 | |
| 20 - 27 * | I | 27 | |
| 20 - 39 * | I | 37 | 2 |
| 20 - 41 | I | 41 | |
| 22 - 21 * | II | | 21 |
| 22 - 32 * | I | 32 | |
| 22 - 34 | I | 34 | |
| 22 - 36 | I | 36 | |
| 22 - 41 * | I | 27 | 14 |
| 22 - 55 | I | 55 | |
| 24 - 61 | I | 61 | |

| Arrangement | Degrees | | | |
|-------------|---------|-----|-----|-----|
| | W | X | Y | Z |
| 8 - 2 | 58 | 122 | | |
| 8 - 3 | 60 | 210 | | |
| 8 - 3A | 60 | | | |
| 8 - 4 | 45 | | | |
| 8 - 33 | 90 | | | |
| 10 - 2 | | | | |
| 10 - 6 | 90 | | | |
| 10 - 7 | 90 | | | |
| 10 - 8 | | | | |
| 10 - 98 | 90 | 180 | 240 | 270 |
| 12 - 3 | | | 180 | |
| 12 - 4 | 38 | | | |
| 12 - 8 | 90 | 112 | 203 | 292 |
| 12 - 10 | 60 | 155 | 270 | 295 |
| 12 - 14 | 60 | 155 | 270 | 295 |
| 12 - A6 | | | | |
| 14 - 5 | 40 | 92 | 184 | 273 |
| 14 - 12 | 43 | 90 | | |
| 14 - 12/3 | | | | |
| 14 - 14 | 17 | 110 | 155 | 234 |
| 14 - 15 | 17 | 110 | 155 | 234 |
| 14 - 18 | 15 | 90 | 180 | 270 |
| 14 - 19 | 30 | 165 | 315 | |
| 16 - 2 | | | | |
| 16 - 8 | 54 | 152 | 180 | 331 |
| 16 - 23 | 158 | 270 | | |
| 16 - 26 | 60 | | 275 | 338 |
| 16 - 99 | 66 | 156 | 223 | 340 |
| 18 - 11 | 62 | 119 | 241 | 340 |
| 18 - 30 | 180 | 193 | 285 | 350 |
| 18 - 32 | 85 | 138 | 222 | 265 |
| 20 - 16 | 238 | 318 | 333 | 347 |
| 20 - 24 | 70 | 145 | 215 | 290 |
| 20 - 25 | 72 | 144 | 216 | 288 |
| 20 - 27 | 72 | 144 | 216 | 288 |
| 20 - 39 | 63 | 144 | 252 | 333 |
| 20 - 41 | 45 | 126 | 225 | |
| 22 - 21 | 16 | 135 | 175 | 349 |
| 22 - 32 | 72 | 145 | 215 | 288 |
| 22 - 34 | 62 | 142 | 218 | 298 |
| 22 - 36 | 72 | 144 | 216 | 288 |
| 22 - 41 | 39 | 135 | 264 | |
| 22 - 55 | 30 | 142 | 226 | 314 |
| 24 - 61 | 90 | 180 | 270 | 324 |

* Consult Factory

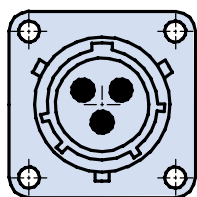

Normal Position

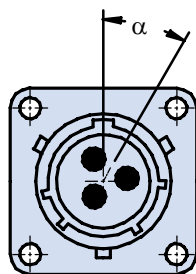

Alternate Position with Pin Contacts

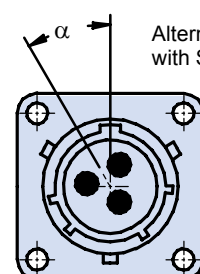

Alternate Position with Socket Contacts

B-10